

2026
GUIDE TO
PREFECTURAL HOUSING

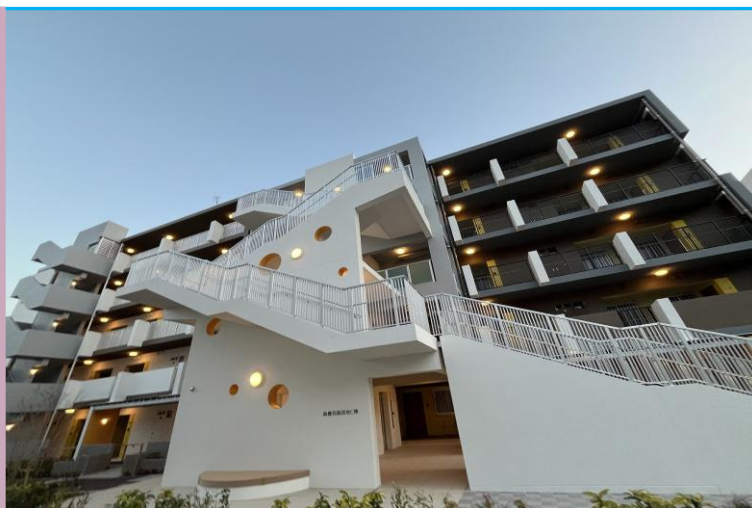

Monthly Application

Accepted from 10 to 18 every
month

Permanent Application

Accepted on a first-come, first-

- Low rent
- No co-signer required
- Young singles welcome
- Priority given to families with children and newlyweds

Questions and Applications (For details, please contact the relevant branch office.)



Kosha
Website



kosha
X

SHIZUOKA-KEN JUTAKU KYOKYU KOUSHA <http://www.sikk.or.jp/kenei/>

(Eastern) TOBU SHISHO Phone Number: 055-920-2271

Ken Tobu Sogo Chosha Honkan 2F, 1-3 Takashima Honcho, Numazu-shi, 410-0055

FUJI SHUCCHOUJO Phone Number: 0545-55-2817

Fuji Shiyakusho Chosha 5F, South Side 1-100 Nagata-cho, Fuji-shi, 417-8601

(Central) Jutaku Service-Ka Phone Number: 054-255-4824

Shizuoka chou Bldg.9F, 9-18 Ote-machi, Aoiku, Shizuoka-shi, 420-0853

(Western) SEIBU SHISHO Phone Number: 053-455-0025

Ken Hamamatsu Sogo Chosha 9F, 1-12-1 Chuo, Chup-ku, Hamamatsu-shi, 430-0929